



**48" TWO DOOR AND DUAL-ZONE
REFRIGERATOR/WINE RESERVE**



*Refrigerator
HC48WS*



*Dual Zone Wine Reserve
HC48WW*

JOB
AREA
ITEM NO.
MODEL NO.



Intertek



MODEL NO.
HC48RS
HC48WS
HC48RW
HC48WW

MODEL NO.		HC48RS	HC48WS	HC48RW	HC48WW
CABINET DIMENSIONS	Length Ins. (mm)	47-7/8" (1216)	47-7/8" (1216)	47-7/8" (1216)	47-7/8" (1216)
	Depth Ins. (mm)	24" (610)	24" (610)	24" (610)	24" (610)
	Height Ins. (mm)	34-3/8" (873)	34-3/8" (873)	34-3/8" (873)	34-3/8" (873)
SHIP WEIGHT LBS. (KG)		375 (170)	375 (170)	375 (170)	375 (170)
CAPACITY CU. FT. (L.)		11.7 (331)	11.7 (331)	11.1 (314)	11.1 (314)
SHELVING		2 black vinyl-coated full-extension shelves (adjustable) per door & floor racks	4 full-extension wine shelves & 6 full-extension wine shelves. Magnum floor rack 1st compartment.	2 black vinyl-coated full-extension shelves (adjustable) & 6 full extension wine shelves	4 full-extension wine shelves & 6 full-extension wine shelves. Magnum floor rack 1st compartment.
TEMPERATURE SETTINGS F°(C)		Range 32°F (0°) - 42°F (5.6°) Factory Set Point 36°F (2.2°)	40°F (4.4°) - 68°F (20°) Factory Set Point 43°F (6.1°)	32°F (0°) - 42°F (5.6°) 40°F (4.4°) - 68°F (20°) Factory Set Point 36°F (2.2°) 43°F (6.1°)	43°F (6.1°) 54°F (12.2°) Factory Set Point 40°F (4.4°) - 68°F (20°) 40°F (4.4°) - 68°F (20°)
CABINET CONSTRUCTION (INT.)		Interior Stainless Steel			
CABINET CONSTRUCTION (EXT.)		Exterior Sides, Exterior Top and Grill Stainless Steel Exterior Back and Exterior Bottom Stainless Steel Door Exterior Customer Choice (see below under 'Customer Options')			
CABINET INSULATION		Polyurethane-Ecomate. Wall Thickness-2" Door Thickness-2"			
DOORS, HINGING & HARDWARE		Number of Doors 2 Opening Style Hinged (Left or Right) Door Style Solid or Glass Door Swing Clearance 25" (635) Locks Available (factory installed)			
CONDENSING UNIT		H.P. 1/6 Condenser Access Front			
REFRIGERATION		Refrigerant 9.0 oz. - R134a Expansion Device Capillary Tube Type w/Hermetic Compressor			
PLUMBING		None required. Moisture drains to self evaporating condensate pan			
ELECTRICAL		Electrical Supply 115V/60 Hz/1 Phase Running Load Amps 2.8 Cord Connection Cord Connected (3-prong 6' NEMA 5-15P) Thermostat Digital Lighting Type LED blue/white			
VENTILATION		Front-vented			
CUSTOMER OPTIONS		Door Finishes Black Vinyl Clad (B), Stainless (S), Glass w/Black Frame (G), Glass w/Stainless Steel Frame (T), Door Handle Options 24" full length two tone, Classic 6" chrome w/black vinyl grip, tab handle (top mount, stainless steel)			

***NOTE:** This equipment is intended for the storage and display of non-potentially hazardous bottled or canned products only!

Form No. Z2420
Rev. 3.4.2016



48" TWO DOOR AND DUAL-ZONE REFRIGERATOR/WINE RESERVE

HC48RS & HC48WS MODELS

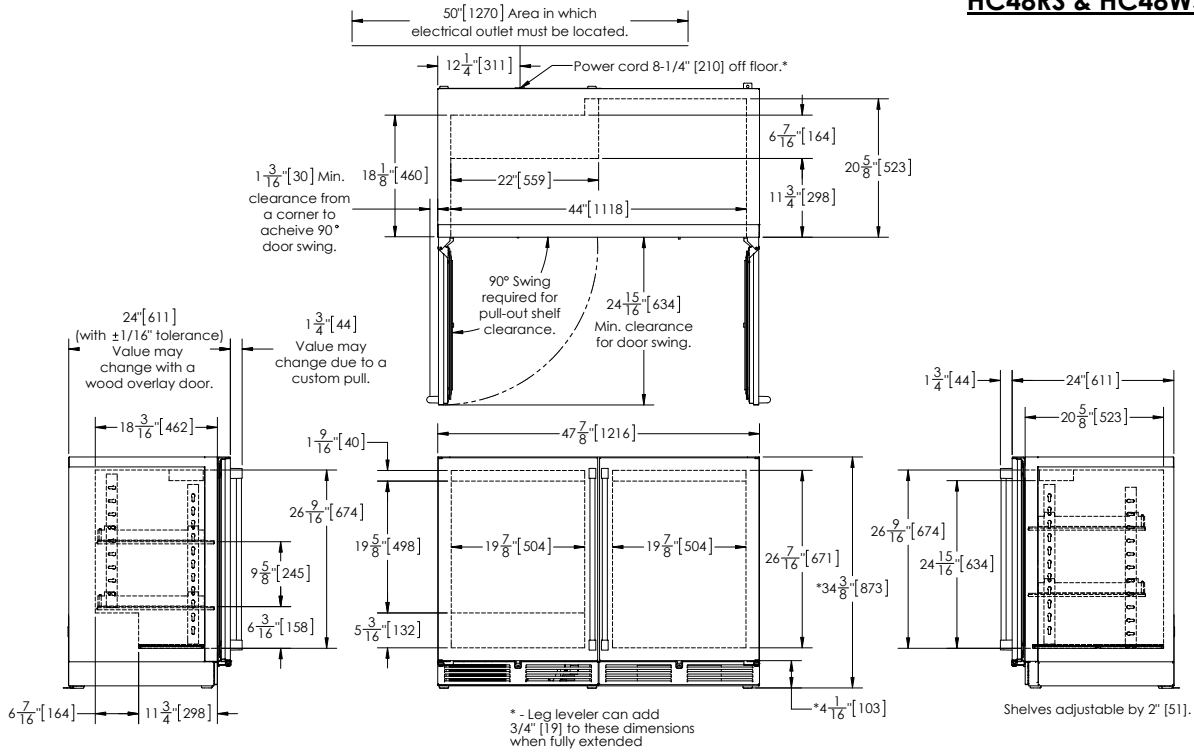

HC48RW & HC48WW MODELS

